

Go to www.vtechphones.com to register your product for enhanced warranty support and the latest Vtech product news.

CS6114
CS6114-11
CS6114-2

DECT 6.0 cordless telephone



Telephones identified with this logo have reduced noise and interference when used with most T-coil equipped hearing aids and cochlear implants. The TIA-1083 Compliant Logo is a trademark of the Telecommunications Industry Association. Used under license.



vtech

Abridged user's manual

Congratulations

on purchasing your new Vtech product. Before using this telephone, please read **Important safety instructions**.

This abridged user's manual provides you with basic installation and use instructions. A limited set of features are described in abbreviated form.

Please refer to the online user's manual for a full set of installation and operation instructions at www.vtechphones.com.

What's in the box

Your telephone package contains the following items. Save your sales receipt and original packaging in the event warranty service is necessary.

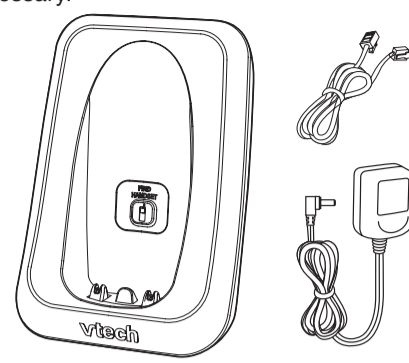

1 set for CS6114/CS6114-11;
2 sets for CS6114-2

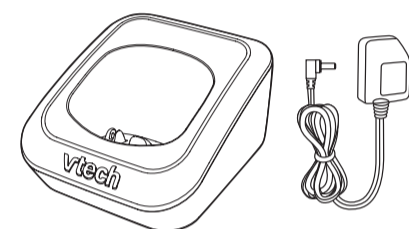

1 set for CS6114-2

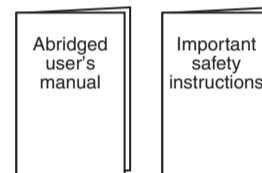

Handset overview

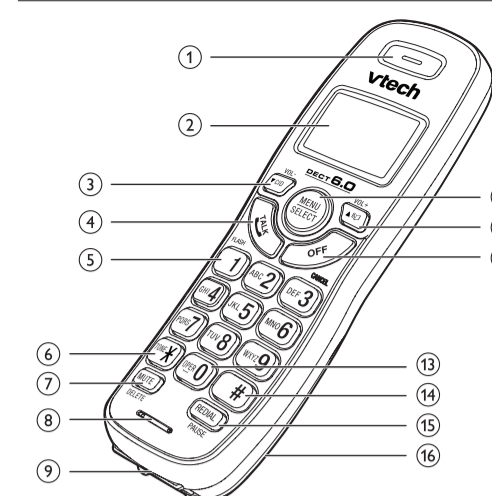

- 1 – **Handset earpiece**
- 2 – **LCD display**
- 3 – **▼CID/VOL-**
 - Review the caller ID log when the telephone is not in use.
 - Scroll down while in a menu, or in the directory, caller ID log or redial list.
 - Move the cursor to the left when entering numbers or names.
 - Decrease the listening volume during a call.
- 4 – **☒/FLASH**
 - Make or answer a call.
 - Answer an incoming call when you receive a call waiting alert.
- 5 – **1**
 - Press repeatedly to add or remove 1 in front of the caller ID log entry before dialing or saving it to the directory.
- 6 – **TONEX**
 - Switch to tone dialing temporarily during a call.
- 7 – **MUTE/DELETE**
 - Mute the microphone during a call.
 - Silence the handset ringer temporarily while the phone is ringing.
 - Delete the displayed entry while reviewing the directory, caller ID log or redial list.
 - Delete digits or characters when entering numbers or names.
- 8 – **Microphone**
- 9 – **Charging pole**
- 10 – **MENU/SELECT**
 - Show the menu.
 - While in a menu, press to select an item, or save an entry or setting.

11 – ▲/VOL+

- Review the directory when the phone is not in use.
- Scroll up while in a menu, or in the directory, caller ID log or redial list.
- Move the cursor to the right when entering numbers or names.
- Increase the listening volume during a call.

12 – OFF/CANCEL

- Hang up a call.
- Return to the previous menu or idle mode without making changes.
- Delete digits while predialing.
- Silence the handset ringer temporarily while the phone is ringing.
- Erase the missed call indicator while the handset is not in use.

13 – 0/OPER

- Enter space character during text editing.

14 –

- Show other dialing options when reviewing a caller ID log entry.

15 – REDIAL/PAUSE

- Review the redial list.
- Insert a dialing pause while dialing or entering numbers into the directory.

16 – Battery compartment cover

Telephone base overview

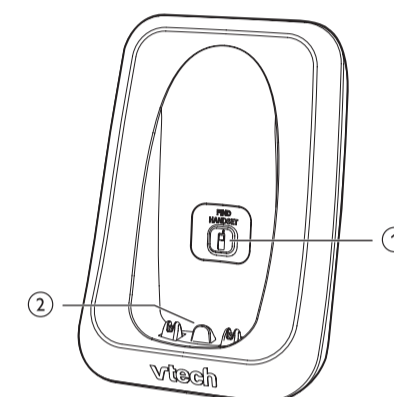

1 – FIND HANDSET

- Page all system handsets.

2 – Charging pole

Charger overview

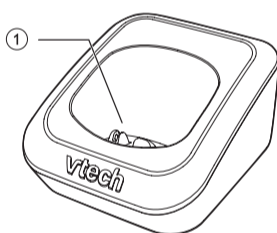

1 – Charging pole

Connect

You can choose to connect the telephone base for desktop usage or wall mounting.

NOTES

- Use only the adapters provided.
- Make sure the electrical outlets are not controlled by wall switches.
- The adapters are intended to be correctly oriented in a vertical or floor mount position. The prongs are not designed to hold the plug in place if it is plugged into a ceiling, under-the-table or cabinet outlet.

TIP

- If you subscribe to digital subscriber line (DSL) high-speed Internet service through your telephone line, make sure you install a **DSL filter** (not included) between the telephone line cord and telephone wall jack. Contact your DSL service provider for more information.

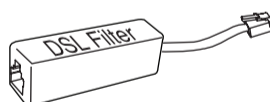

Connect the telephone base

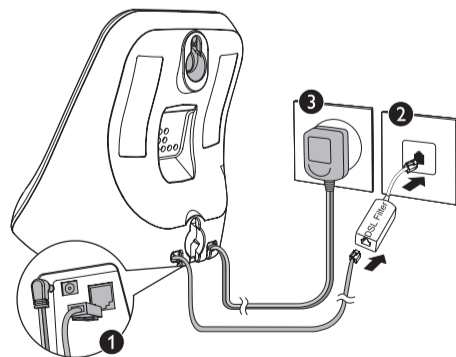

Connect the charger

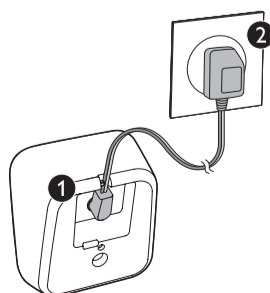

Mount the telephone base

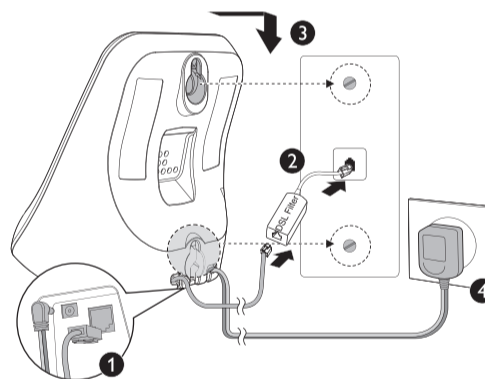

Install and charge the battery

Install the battery

Install the battery as shown below.

NOTES

- Use only supplied battery.
- Charge the battery provided with this product only in accordance with the instructions and limitations specified in this manual.
- If the handset will not be used for a long time, disconnect and remove the battery to prevent possible leakage.

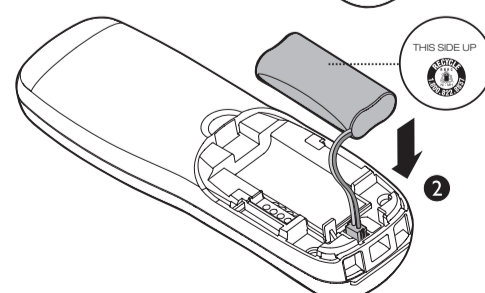
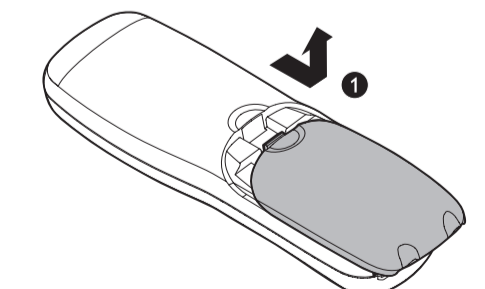

Charge the battery

Place the handset in the telephone base or the charger to charge.

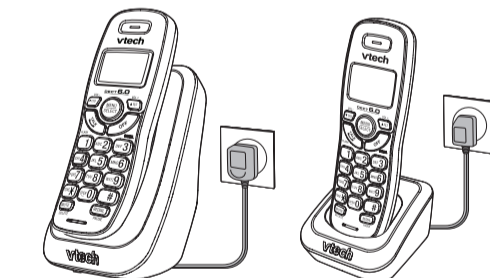

Once you have installed the battery, the handset LCD display indicates the battery status (see the table below).

NOTES

- For best performance, keep the handset in the telephone base or charger when not in use.
- The battery is fully charged after 16 hours of continuous charging.
- If you place the handset in the telephone base or the charger without plugging in the battery, the screen displays **No battery**.

Battery indicators	Battery status	Action
The screen is blank, or displays Put in charger and ! flashes.	The battery has no or very little charge. The handset cannot be used.	Charge without interruption (at least 30 minutes).
The screen displays Low battery and ! flashes.	The battery has enough charge to be used for a short time.	Charge without interruption (about 30 minutes).
The screen displays HANDSET X .	The battery is charged.	To keep the battery charged, place it in the telephone base or charger when not in use.

Before use

After you install your telephone or power returns following a power outage, the handset will prompt you to set the date and time.

Set date and time

- Use the dialing keys (0-9) to enter the month (MM), date (DD) and year (YY). Then press **SELECT**.
- Use the dialing keys (0-9) to enter the hour (HH) and minute (MM). Then press **▼** or **▲** to choose **AM** or **PM**.
- Press **SELECT** to save.

Check for dial tone

Press **☒**. If you hear a dial tone, the installation is successful.

If you do not hear a dial tone:

- Make sure the installation procedures described above are properly done.
- It may be a wiring problem. If you have changed your telephone service to digital service from a cable company or a VoIP service provider, the telephone line may need to be rewired to allow all existing telephone jacks to work. Contact your cable/VoIP service provider for more information.

Operating range

This cordless telephone operates with the maximum power allowed by the Federal Communications Commission (FCC). Even so, this handset and telephone base can communicate over only a certain distance - which can vary with the locations of the telephone base and handset, the weather, and the layout of your home or office.

When the handset is out of range, the handset displays **Out of range or no pwr at base**.

If there is a call while the handset is out of range, it may not ring, or if it does ring, the call may not connect well when you press **☒**. Move closer to the telephone base, then press **☒** to answer the call.

If the handset moves out of range during a telephone conversation, there may be interference. To improve reception, move closer to the telephone base.

Use the handset menu

- Press **MENU** when the phone is not in use.
- Press **▼** or **▲** until the screen displays the desired feature menu.
- Press **SELECT**.

- To return to the previous menu, press **CANCEL**.
- To return to idle mode, press and hold **CANCEL**.

Configure your telephone

Set language

The LCD language is preset to English. You can select English, French or Spanish to be used in all screen displays.

- Press **MENU** when the handset is not in use.
- Scroll to **Settings**, then press **SELECT** twice.
- Scroll to choose **English**, **Français** or **Español**.
- Press **SELECT** twice to save your setting.

Set date and time

- Press **MENU** on the handset when not in use.
- Scroll to **Set date/time** and then press **SELECT**.
- Use the dialing keys (0-9) to enter the month (MM), date (DD) and year (YY). Then press **SELECT**.
- Use the dialing keys (0-9) to enter the hour (HH) and minute (MM). Then press **▼** or **▲** to choose **AM** or **PM**.
- Press **SELECT**.

Temporary tone dialing

If you have pulse (rotary) service only, you can switch from pulse to touch-tone dialing temporarily during a call.

- During a call, press **TONEX**.
- Use the dialing keys to enter the relevant number. The telephone sends touch-tone signals. It automatically returns to pulse dialing mode after you end the call.

Telephone operations

Handset control key panel:

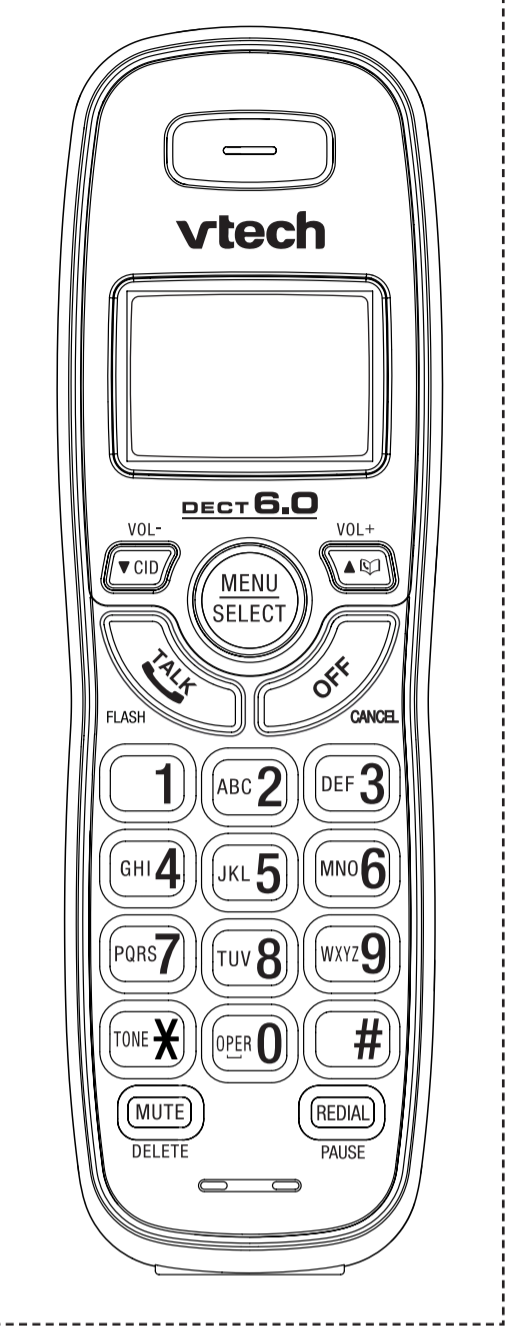

Make a call

- Press **☎**, and then dial the telephone number.

Answer a call

- Press **☎** or any of the dialing keys.

End a call:

- Press **OFF** or put the handset back in the telephone base or charger.

Volume

- During a call, press **VOL-** or **VOL+** to adjust the listening volume.

Mute

The mute function allows you to hear the other party but the other party cannot hear you.

- During a call, press **MUTE**. The handset displays **Muted**.
- Press **MUTE** again to resume the conversation. The handset displays **Microphone on** briefly.

Join a call in progress (for multiple handset models only)

You can use three handsets at a time on an outside call.

- When a handset is already on a call, press **☎** on another handset to join the call.
- To exit the call, press **OFF** on the handset or place it in the telephone base or charger. The call continues until all handsets hang up.

Call waiting

When you subscribe to call waiting service from your telephone service provider, you hear an alert tone if there is an incoming call while you are already on a call.

- Press **FLASH** to put the current call on hold and take the new call.
- Press **FLASH** at any time to switch back and forth between calls.

Find handset

Use this feature to find the system handset.

To start paging:

- Press **☎/FIND HANDSET** on the telephone base when not in use. All idle handsets ring and display **** Paging ****.

Turn off the new voicemail indicators

If you have retrieved your voicemail while away from home, and the handset still displays the new voicemail indicators, use this feature to turn off the indicators.

NOTE

- This feature turns off the indicators only, it does not delete your voicemail messages.

- Press **MENU** when the phone is not in use.
- Scroll to **Settings** and then press **SELECT**.
- Scroll to **Cir voicemail** and then press **SELECT**.
- Press **SELECT** again to confirm.

Register a handset

When your handset is deregistered from the telephone base, follow the steps below to register it back to the telephone base.

- Remove the handset from the telephone base.
- Press and hold **☎/FIND HANDSET** at the telephone base for about four seconds until the **IN USE** light turns on.
- Then press **#** on the handset. It displays **Registering...**

The handset show **Registered** and you hear a beep when the registration process completes.

The registration process takes about 60 seconds to complete.

General product care

Taking care of your telephone

Your cordless telephone contains sophisticated electronic parts, so it must be treated with care.

Avoid rough treatment

Place the handset down gently. Save the original packing materials to protect your telephone if you ever need to ship it.

Avoid water

Your telephone can be damaged if it gets wet. Do not use the handset outdoors in the rain, or handle it with wet hands. Do not install the telephone base near a sink, bathtub or shower.

Electrical storms

Electrical storms can sometimes cause power surges harmful to electronic equipment. For your own safety, take caution when using electrical appliances during storms.

To end paging:

- Press **☎/FIND HANDSET** at the telephone base.

-OR-

- Press **☎** or any of the dialing keys on the handset.

NOTE

- Do not **press and hold ☎/FIND HANDSET** for more than four seconds. It may lead to handset deregistration.

Redial list

Each handset stores the last five telephone numbers dialed. When there are already five entries, the oldest entry is deleted to make room for the new entry.

Review and dial a redial list entry

- Press **REDIAL** when the handset is not in use.
- Press **▼**, **▲** or **REDIAL** repeatedly until the desired entry displays.
- Press **☎** to dial.

Delete a redial list entry

- When the desired redial entry displays, press **DELETE**.

Directory

The directory can store up to 30 entries, which are shared by all handsets. Each entry may consist of a telephone number up to 30 digits, and a name up to 15 characters.

Add a directory entry

- Enter the number when the phone is not in use. Press **MENU**, then go to Step 3.

-OR-

Press **MENU** when the phone is not in use, then press **SELECT** to choose **Directory**. Press **SELECT** again to choose **Add contact**.

- Use the dialing keys to enter the number.
 - OR-** Copy a number from the redial list by pressing **REDIAL** and then press **▼**, **▲** or **REDIAL** repeatedly to select a number. Press **SELECT** to copy the number.
- Press **SELECT** to move on to enter the name.
- Use the dialing keys to enter the name. Additional key presses show other characters of that particular key.
- Press **SELECT** to save.

While entering names and numbers, you can:

- Press **DELETE** to backspace and erase a digit or character.
- Press and hold **DELETE** to erase the entire entry.
- Press **▼** or **▲** to move the cursor to the left or right.
- Press and hold **PAUSE** to insert a dialing pause (for entering numbers only).
- Press 0 to add a space (for entering names only).

Review a directory entry

Entries are sorted alphabetically.

- Press **☎** when the phone is not in use.
- Scroll to browse through the directory, or use the dialing keys to start a name search.

Delete a directory entry

- When the desired entry displays, press **DELETE**.
- When the handset displays **Delete contact?**, press **SELECT**.

Edit a directory entry

- When the desired entry displays, press **SELECT**.
- Use the dialing keys to edit the number, then press **SELECT**.
- Use the dialing keys to edit the name, then press **SELECT**.

Dial a directory entry

- When the desired entry appears, press **☎** to dial.

Caller ID

If you subscribe to caller ID service, information about each caller appears after the first or second ring. If you answer a call before the caller information appears on the screen, it will not be saved in the caller ID log.

The caller ID log stores up to 30 entries. Each entry has up to 24 digits for the phone number and 15 characters for the name.

If the telephone number has more than 15 digits, only the last 15 digits appear. If the name has more than 15 characters, only the first 15 characters are shown and saved in the caller ID log.

Review a caller ID log entry

- Press **CID** when the phone is not in use.
- Scroll to browse through the caller ID log.

Product

Product that has been subjected to misuse, accident, shipping or other physical damage, improper installation, abnormal operation or handling, neglect, inundation, fire, water or other liquid intrusion;

- Product whose warranty/quality stickers, product serial number plates or electronic serial numbers have been removed, altered or rendered illegible;
- Product purchased, used, serviced, or shipped for repair from outside the United States of America or Canada, or used for commercial or institutional purposes (including but not limited to Products used for rental purposes);
- Product returned without a valid proof of purchase (see item 2 below); or
- Charges for installation or set up, adjustment of customer controls, and installation or repair of systems outside the unit.

How do you get warranty service?

To obtain warranty service in the USA, please visit our website at www.vtechphones.com or call 1 (800) 595-9511. In Canada, go to www.vtechcanada.com or call 1 (800) 267-7377.

NOTE: Before calling for service, please review the user’s manual - a check of the Product’s controls and features may save you a service call. Except as provided by applicable law, you assume the risk of loss or damage during transit and transportation and are responsible for delivery or handling charges incurred in the transport of the Product(s) to the service location. VTech will return repaired or replaced Product under this limited warranty. Transportation, delivery or handling charges are prepaid. VTech assumes no risk for damage or loss of the Product in transit. If the Product failure is not covered by this limited warranty, or proof of purchase does not meet the terms of this limited warranty, VTech will notify you and will request that you authorize the cost of repair prior to any further repair activity. You must pay for the cost of repair and return shipping costs for the repair of Products that are not covered by this limited warranty.

What must you return with the Product to get warranty service?

- Return the entire original package and contents including the Product to the VTech service location along with a description of the malfunction or difficulty; and
- Include a “valid proof of purchase” (sales receipt) identifying the Product purchased (Product model) and the date of purchase or receipt; and
- Provide your name, complete and correct mailing address, and telephone number.

Other limitations

This warranty is the complete and exclusive agreement between you and VTech. It supersedes all other written or oral communications related to this Product. VTech provides no other warranties for this Product. The warranty exclusively describes all of VTech’s responsibilities regarding the Product. There are no other

Missed call indicator

When there are calls that have not been reviewed in the caller ID log, the handset displays **XX missed calls**.

Each time you review a caller ID log entry marked **NEW**, the number of missed calls decreases by one.

When you have reviewed all the missed calls, the missed call indicator no longer displays.

If you do not want to review the missed calls one by one, press and hold **CANCEL** on the idle handset to erase the missed call indicator. All the entries are then considered old.

Dial a caller ID log entry

- When the desired entry appears, press **☎** to dial.

Save a caller ID log entry to the directory

- When the desired caller ID log entry displays, press **SELECT**.
- Use the dialing keys to modify the number, if necessary. Then press **SELECT**.
- Use the dialing keys to modify the name, if necessary. Then press **SELECT**.

Delete the caller ID log entries

- When the desired caller ID log entry displays, press **DELETE**.

To delete all caller ID log entries:

- Press **MENU** when the phone is not in use.
- Scroll to **Caller ID log** and then press **SELECT**.
- Scroll to **Del all calls** then press **SELECT** twice.

Sound settings

Key tone

You can turn the key tone on or off.

- Press **MENU** when the handset is not in use.
- Scroll to **Settings** and then press **SELECT**.
- Scroll to choose **Key tone**, then press **SELECT**.
- Press **▼** or **▲** to choose **On** or **Off**, then press **SELECT** to save.

Ringer tone

You can choose from different ringer tones for each handset.

- Press **MENU** when the handset is not in use.
- Scroll to **Ringers** and then press **SELECT**.
- Scroll to choose **Ringer tone**, then press **SELECT**.
- Press **▼** or **▲** to sample each ringer tone, then press **SELECT** to save.

Product

Product that has been subjected to misuse, accident, shipping or other physical damage, improper installation, abnormal operation or handling, neglect, inundation, fire, water or other liquid intrusion;

Product whose warranty/quality stickers, product serial number plates or electronic serial numbers have been removed, altered or rendered illegible;

State/Provincial Law Rights: This warranty gives you specific legal rights, and you may also have other rights, which vary from state to state or province to province.
Limitations: Implied warranties, including those of fitness for a particular purpose and merchantability (an unwritten warranty that the Product is fit for ordinary use) are limited to one year from the date of purchase. Some states/provinces do not allow limitations on how long an implied warranty lasts, so the above limitation may not apply to you. In no event shall VTech be liable for any indirect, special, incidental, consequential, or similar damages (including, but not limited to lost profits or revenue, inability to use the Product or other associated equipment, the cost of substitute equipment, and claims by third parties) resulting from the use of this Product. Some states/provinces do not allow the exclusion or limitation of incidental or consequential damages, so the above limitation or exclusion may not apply to you.

Please retain your original sales receipt as proof of purchase.

NOTE

- If you turn off the ringer volume, you will not hear ringer tone samples.

Ringer volume

You can adjust the ringer volume level, or turn the ringer off.

- Press **MENU** when the handset is not in use.
- Scroll to **Ringers** and then press **SELECT** twice.
- Press **▼** or **▲** to sample each volume level, then press **SELECT** to save.

NOTE

- When the ringer volume is set to **Off**, the handset still rings when you press **☎/FIND HANDSET** at the telephone base.

Temporary ringer silencing

When the telephone is ringing, you can temporarily silence the ringer without disconnecting the call. The next call rings normally at the preset volume.

To silence the handset ringer:

- Press **CANCEL** or **MUTE**. The handset displays **Ringer muted**.

Product

Product that has been subjected to misuse, accident, shipping or other physical damage, improper installation, abnormal operation or handling, neglect, inundation, fire, water or other liquid intrusion;

Product whose warranty/quality stickers, product serial number plates or electronic serial numbers have been removed, altered or rendered illegible;

Retrieve voicemail from telephone service

Voicemail is a feature available from most telephone service providers. It may be included with your telephone service, or may be optional. Fees may apply.

When you received a voicemail, the handset displays **☑** and **New voicemail**. To retrieve, you typically dial an access number provided by your telephone service provider, and then enter a security code. Contact your telephone service provider for instructions on how to configure the voicemail settings and listen to messages.

NOTE

- After you have listened to all new voicemail messages, the indicators on the handset turn off automatically.

Product

Product that has been subjected to misuse, accident, shipping or other physical damage, improper installation, abnormal operation or handling, neglect, inundation, fire, water or other liquid intrusion;

Product whose warranty/quality stickers, product serial number plates or electronic serial numbers have been removed, altered or rendered illegible;

Product purchased, used, serviced, or shipped for repair from outside the United States of America or Canada, or used for commercial or institutional purposes (including but not limited to Products used for rental purposes);

Product returned without a valid proof of purchase (see item 2 below); or

Charges for installation or set up, adjustment of customer controls, and installation or repair of systems outside the unit.

Product that has been subjected to misuse, accident, shipping or other physical damage, improper installation, abnormal operation or handling, neglect, inundation, fire, water or other liquid intrusion;

Product whose warranty/quality stickers, product serial number plates or electronic serial numbers have been removed, altered or rendered illegible;

Product purchased, used, serviced, or shipped for repair from outside the United States of America or Canada, or used for commercial or institutional purposes (including but not limited to Products used for rental purposes);

Product returned without a valid proof of purchase (see item 2 below); or

Charges for installation or set up, adjustment of customer controls, and installation or repair of systems outside the unit.

Product that has been subjected to misuse, accident, shipping or other physical damage, improper installation, abnormal operation or handling, neglect, inundation, fire, water or other liquid intrusion;

Product whose warranty/quality stickers, product serial number plates or electronic serial numbers have been removed, altered or rendered illegible;

Product purchased, used, serviced, or shipped for repair from outside the United States of America or Canada, or used for commercial or institutional purposes (including but not limited to Products used for rental purposes);

Product returned without a valid proof of purchase (see item 2 below); or



Designed to fit your home. And your life.

VTech Communications, Inc. A member of THE VTECH GROUP OF COMPANIES. VTech is a registered trademark of VTech Holdings Limited. Specifications are subject to change without notice. © 2014 VTech Communications, Inc. All rights reserved. 12/14. CS6114-X_ACIB_V5.0 Document order number: 91-007041-050-100

